

- ① Concrete Roof Slab laid to Fall
- ② EQUUS SOPREMA Sopradere Quick or Aquadere bitumen primer
- ③ EQUUS SOPREMA vapour barrier as specified
- ④ EQUUS SOPREMA SOPRAROCK mineral wool thermal insulation
- ⑤ EQUUS SOPREMA Soprastick or DeboFlex, Base sheet
- ⑥ EQUUS SOPREMA DuO High Tech 4 Slates/F C180 Firecare cap sheet
- ⑦ Plywood Plinth
- ⑧ EQUUS SOPREMA Alsan Flashing (Quadro) or Equus Matacryn
- ⑨ 3 MM Foam tape on the underside of Baseplate
- ⑩ Fixing Screw
- ⑪ Neoprene Washer
- ⑫ Fall Restraint Anchor

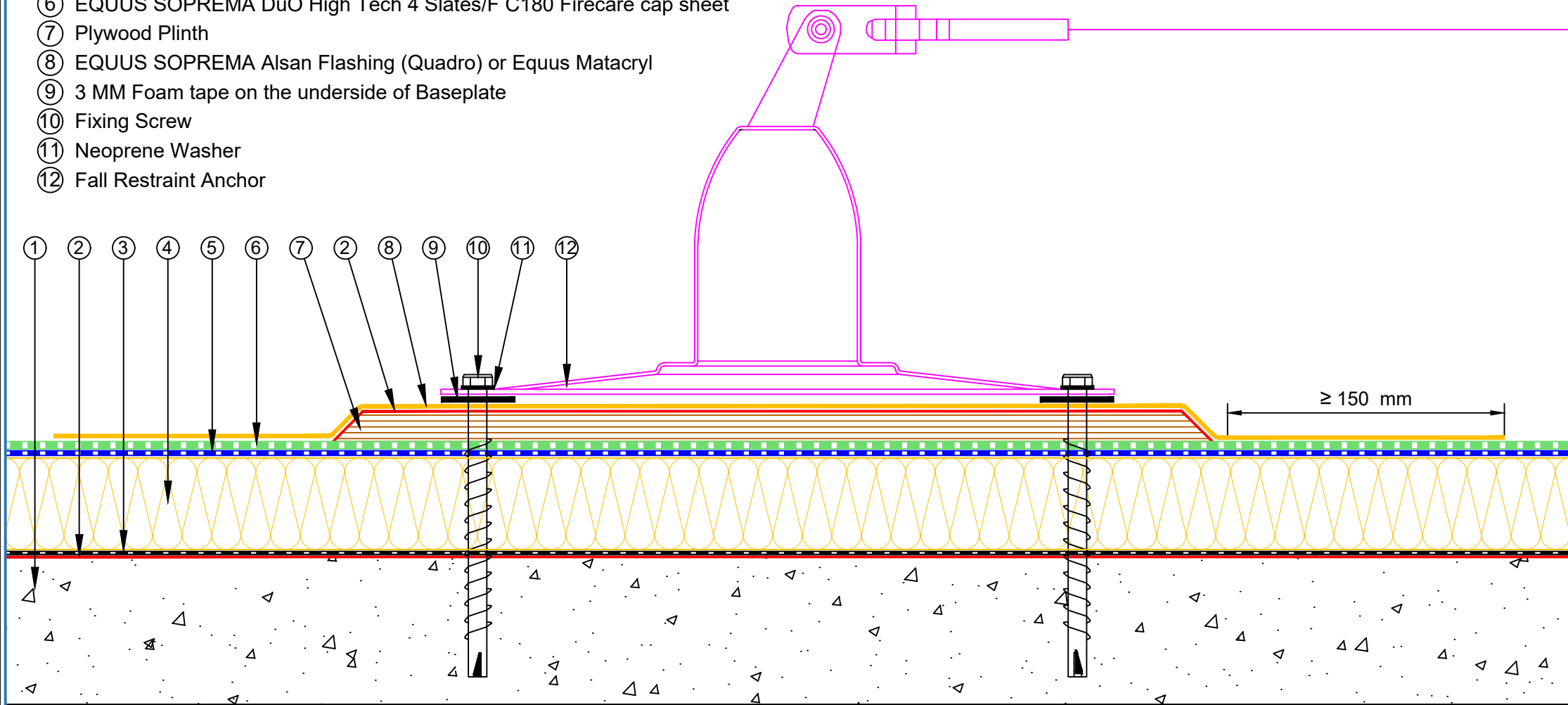

E-mail : info@equus.nz
 Web : www.equus.co.nz

PROJECT :	Warm Roof on Concrete Standard Detail - DuO		
TITLE :	Fall restraint (Mineral wool insulation)		
NUMBER :	SDWRC-D7b	SCALE :	NTS
DRAWN BY :	NKT	DATE :	31-Aug-2022
		REVISED :	28-Apr-2026

Equus Waterproof Membrane Details are specially drawn for use by Local Authorities, Building Contractors, Equus Applicators, Architects and design professionals. All details are drawn to assist in the development of project specific details. Details may be modified where necessary to accommodate job specific requirements but must be approved by Equus Industries Ltd. All components must be supplied by Equus Industries Ltd. Equus reserves the right to alter or upgrade details at any time without prior notice.

