



WATERPROOFING

# COLPHENE<sup>®</sup> 3000 FOUNDATIONS



## SELF-ADHESIVE WATERPROOFING MEMBRANE FOR FOUNDATIONS

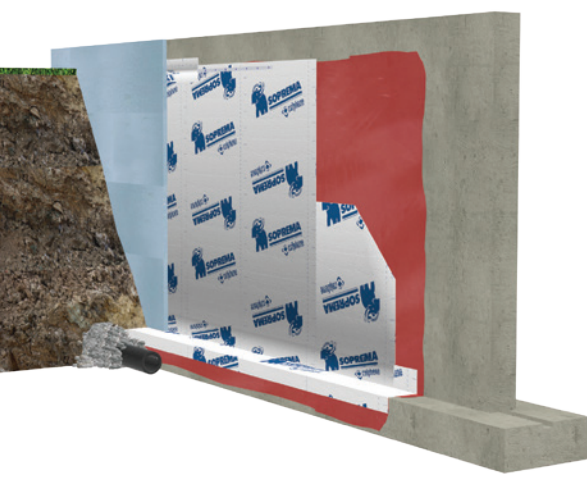

COLPHENE 3000 self-adhesive membrane is made from the most reliable SBS modified bitumen in the industry and has a tri-laminated woven polyethylene facer. It is extremely flexible, easy to handle, and fits easily around the sharp contours and angles of concrete footings and foundations. COLPHENE 3000 is the perfect solution for below grade and foundation wall post-applied waterproofing in areas with low hydrostatic water pressure risk.

- Superior flexibility
- Puncture resistant with high tensile strength
- Consistent thickness

### SURFACE PREPARATION

COLPHENE 3000 must always be installed on clean, dry, solid substrates, which have been primed before application with Equus Peel and Stick primer (solvent- or water based).

### ACCESSORIES

#### Equus Peel and Stick primer

Used to prepare surfaces before the installation of COLPHENE 3000 membrane.

#### SOPRASEAL Sealant

Bituminous sealant used to fill joints and to seal the termination profile.

#### Termination Profile

Mechanically fastened profile to terminate COLPHENE 3000 membrane.

#### Drainage and Protection layer

Drainage sheet installed on top of the COLPHENE 3000 membrane after installation.

COLPHENE 3000	
THICKNESS	1.5 mm
DIMENSIONS	1m x 18.7m
SURFACE	Tri-laminated woven polyethylene
UNDERFACE	Silicone release film



## INSTALLATION INSTRUCTIONS

1



Prime the substrate with Equus Peel and Stick primer (solvent- or water-based)

2



Peel back the top part of the silicone release film. Adhere COLPHENE 3000 to the substrate, making sure the membrane is well aligned.

3



Gradually peel back the remaining silicone release film, making sure the membrane is completely adhered.  
The use of a hand roller is required to remove air pockets.

4



Use a Termination Bar and SOPRASEAL Sealant to seal details and critical areas. The use of an Equus approved protection and drainage board is recommended before backfilling to ensure the integrity of the waterproofing membrane.

5



Completed waterproofing project.

If you have any questions about this product or its installation, please contact Equus, your SOPREMA Authorised Distributor.

 **masterspec partner**

4131EB Equus Soprema  
COLPHENE Tanking Membrane

  
**equus**

 **SOPREMA**  
Authorised Distributor

[www.equus.nz](http://www.equus.nz)

[info@equus.nz](mailto:info@equus.nz)

  
**BRANZ Appraised**  
Appraisal No.1037 [2023]