

- ① Metal Deck
- ② EQUUS Colphene 3000 Vapour Barrier
- ③ EQUUS PIR thermal insulation
- ④ EQUUS Approved adhesive for TPO single ply waterproofing membrane
- ⑤ EQUUS FLAGON TPO single ply waterproofing membrane
- ⑥ 40 mm welded lap
- ⑦ EQUUS FLAGON TPO as separate piece
- ⑧ EQUUS FLAGON Mastic
- ⑨ Stainless steel clamp
- ⑩ EQUUS FLAGON TPO Compatible Sealant

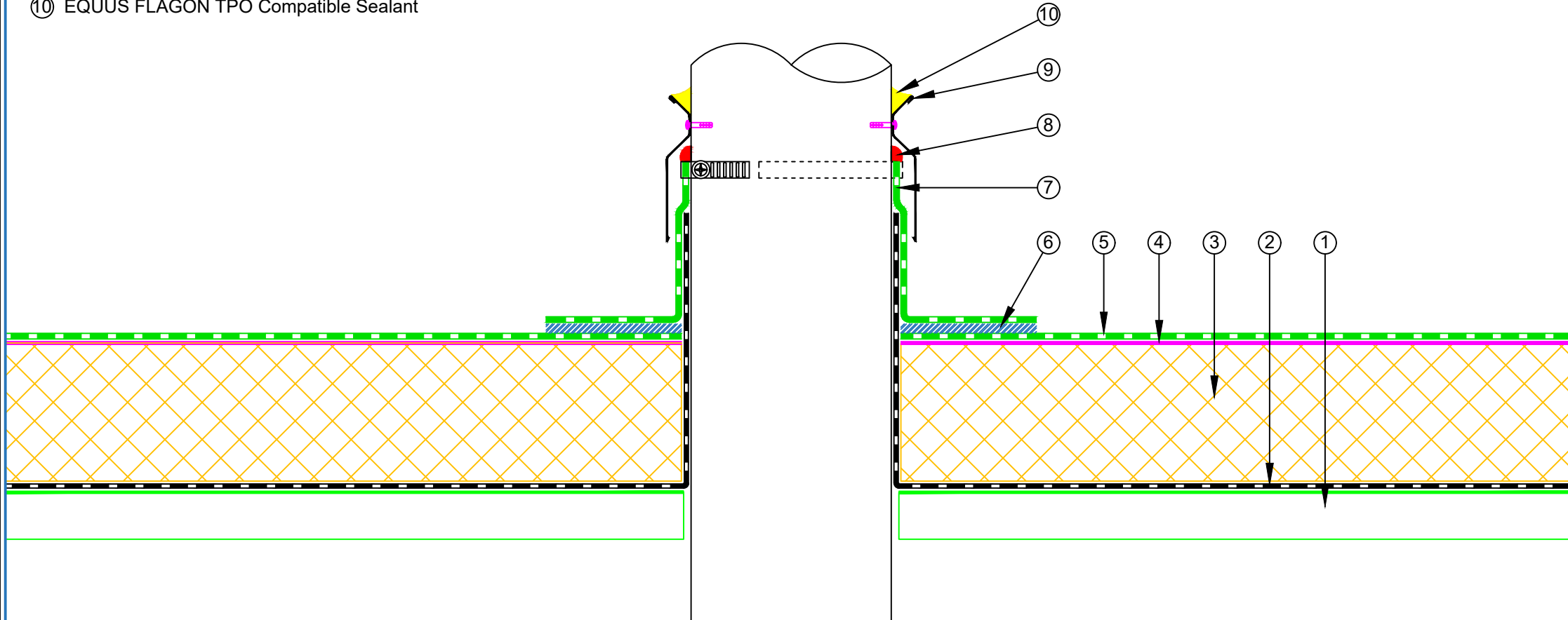

E-mail : [admin@equus.co.nz](mailto:admin@equus.co.nz)  
 Web : [www.equus.co.nz](http://www.equus.co.nz)

PROJECT :	Single ply warm roof system on metal standard Detail - TPO				
TITLE :	Roof Penetration				
NUMBER :	STWRM-D7a			SCALE :	NTS
DRAWN BY :	NKT	DATE :	10-Feb-2023	REVISED :	

Equus Waterproof Membrane Details are specially drawn for use by Local Authorities, Building Contractors, Equus Applicators, Architects and design professionals. All details are drawn to assist in the development of project specific details. Details may be modified where necessary to accommodate job specific requirements but must be approved by Equus Industries Ltd. All components must be supplied by Equus Industries Ltd. Equus reserves the right to alter or upgrade details at any time without prior notice.

