

- ① Plywood Deck
- ② EQUUS SOPRADERE QUICK primer
- ③ EQUUS Colphene 3000 Vapour Barrier
- ④ EQUUS PIR thermal insulation
- ⑤ Plywood
- ⑥ EQUUS SOPRASUN PLUS 3 base sheet
- ⑦ EQUUS SOPRASUN PLUS MINERAL cap sheet
- ⑧ Allproof dome clamp ring drain

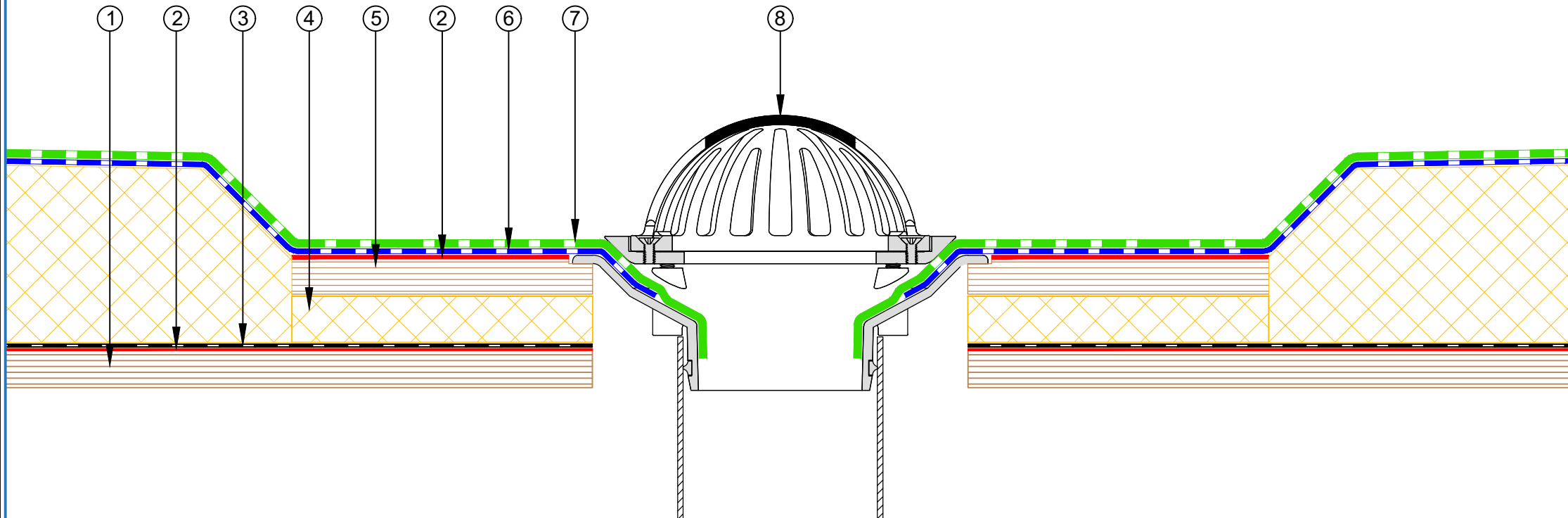

E-mail : admin@equus.co.nz
 Web : www.equus.co.nz

| | | | |
|------------|---|-----------|-------------|
| PROJECT : | Warm Roof on Plywood Standard Detail - SOPRASUN | | |
| TITLE : | Allproof dome clamp ring drain | | |
| NUMBER : | SSWRP-D3a | SCALE : | 1 : 3 |
| DRAWN BY : | NKT | DATE : | 29-Aug-2022 |
| | | REVISED : | |

Equus Waterproof Membrane Details are specially drawn for use by Local Authorities, Building Contractors, Equus Applicators, Architects and design professionals. All details are drawn to assist in the development of project specific details. Details may be modified where necessary to accommodate job specific requirements but must be approved by Equus Industries Ltd. All components must be supplied by Equus Industries Ltd. Equus reserves the right to alter or upgrade details at any time without prior notice.

