

- ① Plywood Deck
- ② EQUUS SOPRADERE QUICK primer
- ③ EQUUS SOPRASUN PLUS 3 base sheet
- ④ EQUUS SOPRASUN PLUS MINERAL cap sheet
- ⑤ Cavity Batten
- ⑥ EQUUS bitumen fillet or approved alternative
- ⑦ Aquaknight S/S Scupper (E2) 200x75 (Code: 2100.104SS)
- ⑧ EQUUS universal Leaf Catcher
- ⑨ EQUUS SOPRASUN Capsheet, as separate piece over Roof Edge Profile
- ⑩ EQUUS Roof Edge Profile
- ⑪ Building wrap boot seal by others
- ⑫ Cladding penetration-refer cladding manufactures details

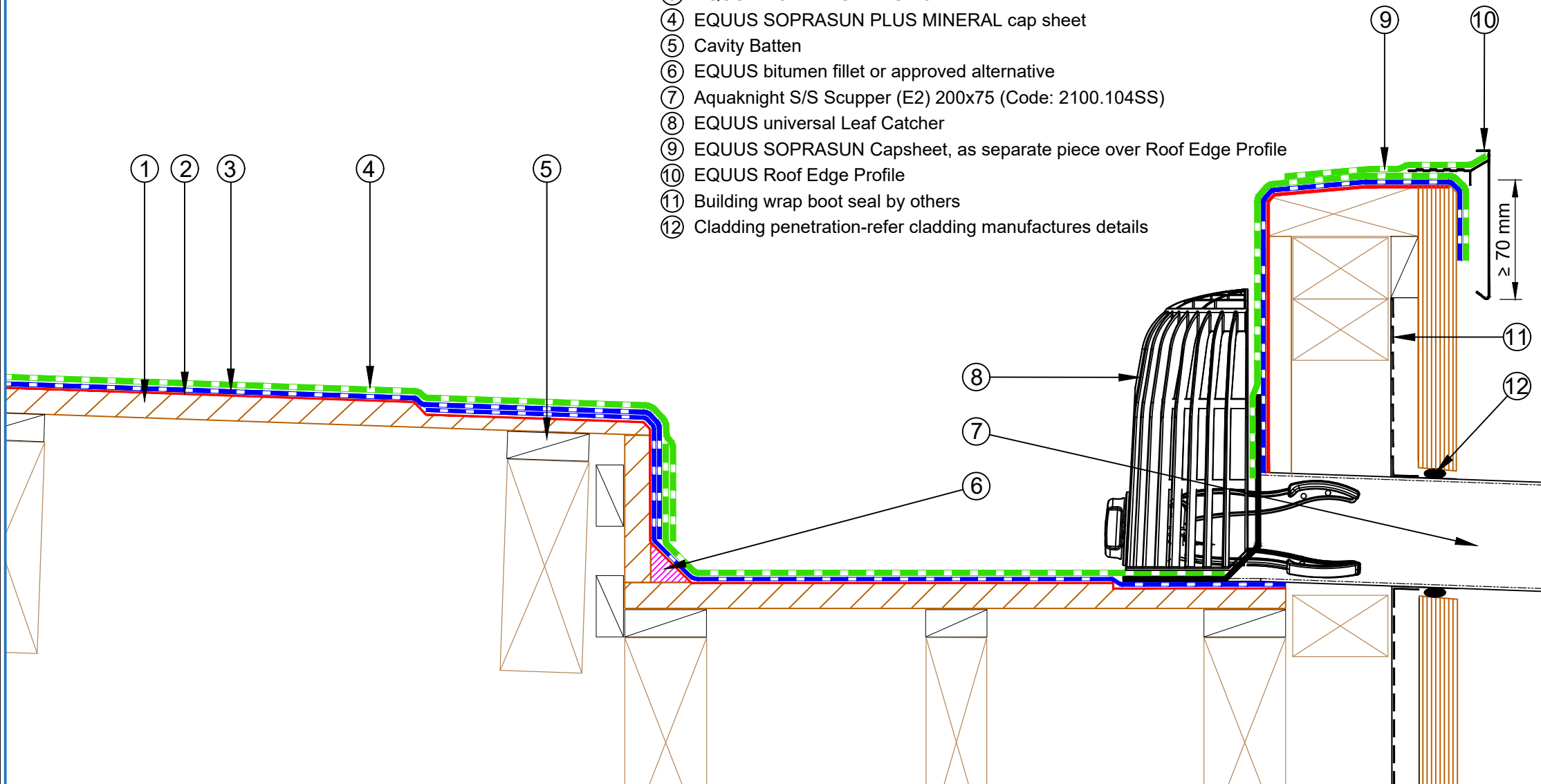

E-mail : [admin@equus.co.nz](mailto:admin@equus.co.nz)  
 Web : [www.equus.co.nz](http://www.equus.co.nz)

PROJECT :	Cold Roof on Plywood Standard Detail		
TITLE :	Aquaknight S/S Scupper Detail		
NUMBER :	SSCRP-D9b	SCALE :	1:2
DRAWN BY :	NKT	DATE :	15-Jun-2022
		REVISED :	

Equus Waterproof Membrane Details are specially drawn for use by Local Authorities, Building Contractors, Equus Applicators, Architects and design professionals. All details are drawn to assist in the development of project specific details. Details may be modified where necessary to accommodate job specific requirements but must be approved by Equus Industries Ltd. All components must be supplied by Equus Industries Ltd. Equus reserves the right to alter or upgrade details at any time without prior notice.

