

- ① Concrete Roof Slab laid to Fall
- ② EQUUS SOPRADERE QUICK primer
- ③ EQUUS SOPRASUN PLUS 3 base sheet
- ④ EQUUS SOPRASUN PLUS MINERAL cap sheet
- ⑤ EQUUS cap sheet as separate piece over Batten
- ⑥ Roof Equipment
- ⑦ EPDM Washer under Screwhead
- ⑧ Timber Roof Batten

STEP 2: Fixing of the Equipment

STEP 1: Fixing of the batten

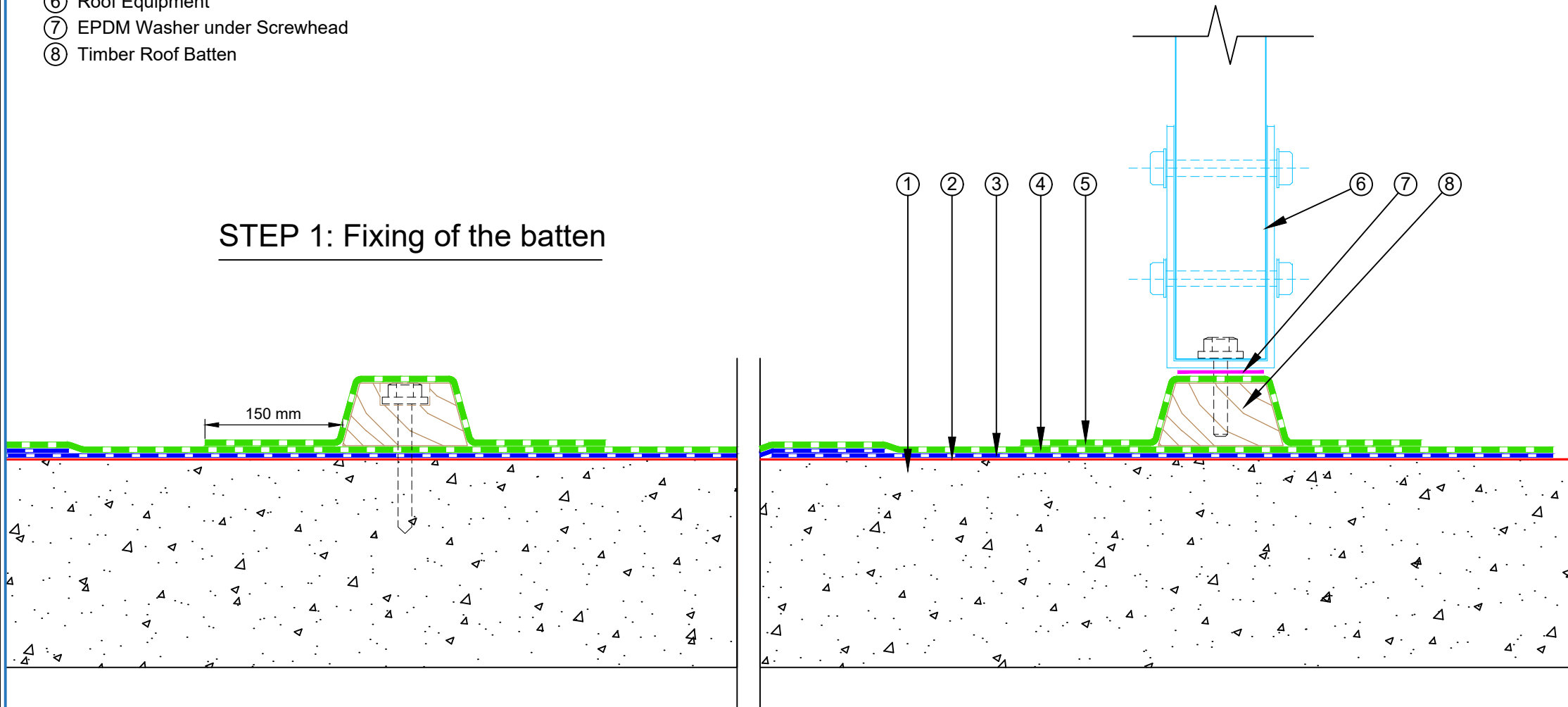

E-mail : admin@equus.co.nz
 Web : www.equus.co.nz

PROJECT :	Cold Roof on Concrete Standard Detail				
TITLE :	Roof Equipment Support Batten				
NUMBER :	SSCRC-D6a			SCALE :	1:4
DRAWN BY :	NKT	DATE :	22-July-2022	REVISED :	

Equus Waterproof Membrane Details are specially drawn for use by Local Authorities, Building Contractors, Equus Applicators, Architects and design professionals. All details are drawn to assist in the development of project specific details. Details may be modified where necessary to accommodate job specific requirements but must be approved by Equus Industries Ltd. All components must be supplied by Equus Industries Ltd. Equus reserves the right to alter or upgrade details at any time without prior notice.

