

- ① Metal Roof Deck
- ② EQUUS Colphene 3000 Vapour Barrier
- ③ EQUUS Mineral wool insulation
- ④ EQUUS Permabase Dek roof cover board
- ⑤ EQUUS Peel & Stick primer
- ⑥ EQUUS NOVA-SK base sheet (self-adhered)
- ⑦ EQUUS NOVA-SK MINERAL cap sheet (self-adhered)
- ⑧ EQUUS DoubleStick Micro Sealant Putty Tape
- ⑨ Flange of Electrical Conduit
- ⑩ EQUUS cap sheet as separate piece over Flange
- ⑪ EQUUS Alsan Flashing (Quadro) or Equus Matacryn
- ⑫ Electrical Conduit with Flange

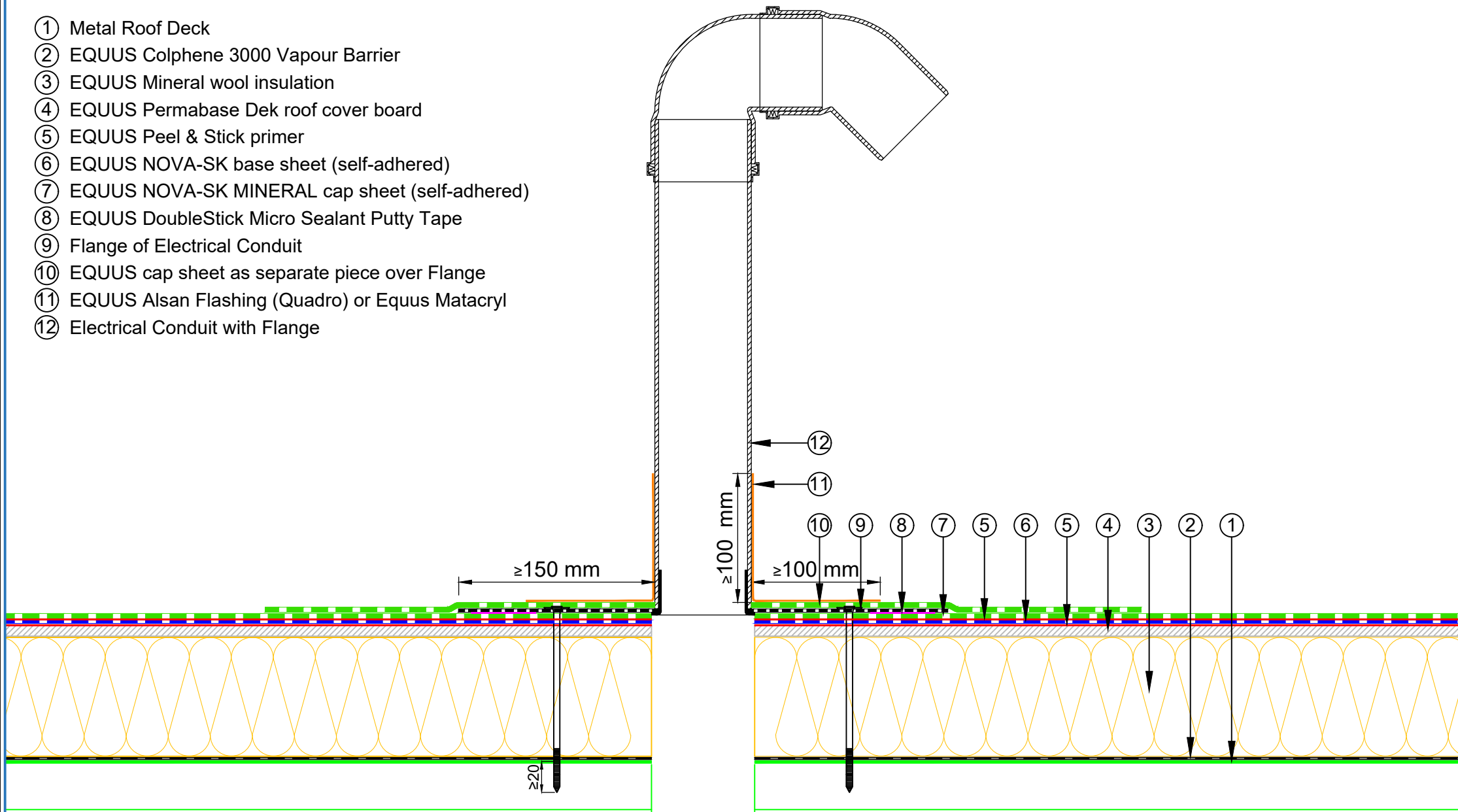

PROJECT :	Warm Roof on Metal Standard Detail - NOVA-SK FLAMELSS SYSTEM				
TITLE :	Electrical conduit with roof cover board (Mineral wool insulation)				
NUMBER :	SNWRM-D6c			SCALE :	NTS
DRAWN BY :	NKT	DATE :	30-Aug-2024	REVISED :	

Equus Waterproof Membrane Details are specially drawn for use by Local Authorities, Building Contractors, Equus Applicators, Architects and design professionals. All details are drawn to assist in the development of project specific details. Details may be modified where necessary to accommodate job specific requirements but must be approved by Equus Industries Ltd. All components must be supplied by Equus Industries Ltd. Equus reserves the right to alter or upgrade details at any time without prior notice.

