

- ① Plywood Deck
- ② EQUUS Peel & Stick primer
- ③ EQUUS NOVA-SK base sheet (self-adhered)
- ④ EQUUS NOVA-SK MINERAL cap sheet
- ⑤ EQUUS cap sheet as separate piece over Plywood Plinth
- ⑥ Plywood Plinth
- ⑦ EQUUS Alsan Mastic 2200 bitumen sealant
- ⑧ EQUUS Alsan Flashing (Quadro) or Equus Matacryn
- ⑨ SHS penetration

Note: check compatibility with pipe material

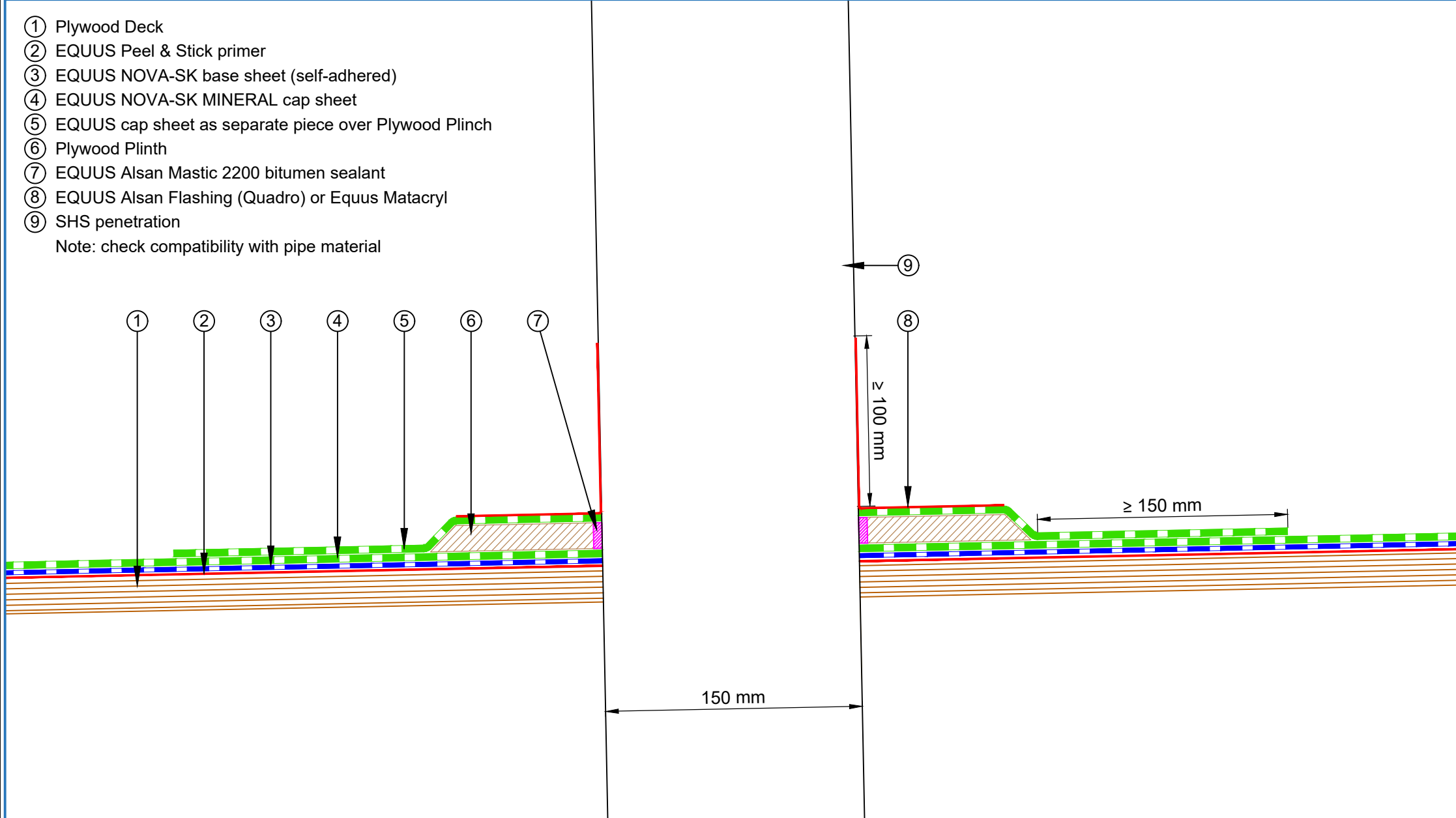

| | | | | | |
|------------|--------------------------------------|--------|-------------|-----------|-----|
| PROJECT : | Cold Roof on Plywood Standard Detail | | | | |
| TITLE : | Pipe Penetration | | | | |
| NUMBER : | SNCRP-D4a | | | SCALE : | 1:3 |
| DRAWN BY : | NKT | DATE : | 17-Jun-2022 | REVISED : | |

Equus Waterproof Membrane Details are specially drawn for use by Local Authorities, Building Contractors, Equus Applicators, Architects and design professionals. All details are drawn to assist in the development of project specific details. Details may be modified where necessary to accommodate job specific requirements but must be approved by Equus Industries Ltd. All components must be supplied by Equus Industries Ltd. Equus reserves the right to alter or upgrade details at any time without prior notice.

