

Shrink Sleeve	
Internal diameter Body	Sleeve shrinkable to
18 mm	8 mm
22 mm	12 mm
42 mm	22 mm
55 mm	42 mm
66 mm	55 mm
88 mm	66 mm
110 mm	88 mm

- ① Concrete Roof Slab laid to Fall
- ② EQUUS Peel & Stick primer
- ③ EQUUS NOVA-SK base sheet (self-adhered)
- ④ EQUUS base sheet as separate piece over Plywood Plinch
- ⑤ EQUUS NOVA-SK MINERAL cap sheet
- ⑥ EQUUS cap sheet, as separate piece over Shrink Sleeve
- ⑦ Plywood Plinth
- ⑧ Bitumen Flange attached to Shrink Sleeve Body
- ⑨ EQUUS Alsan Mastic 2200 bitumen sealant
- ⑩ Shrink Sleeve Body internal diameter 55 mm
- ⑪ Shrink Sleeve

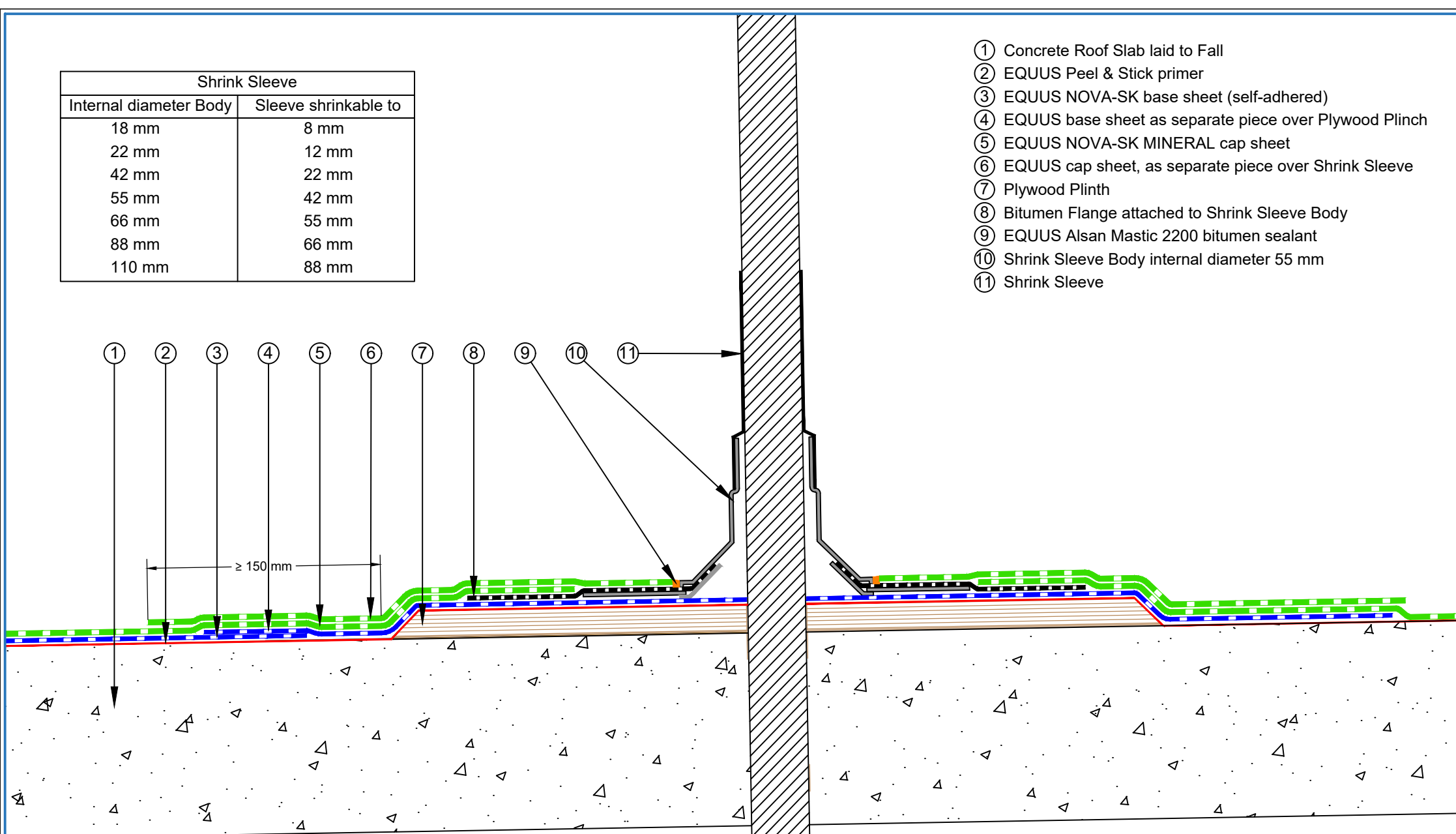

PROJECT :	Cold Roof on Concrete Standard Detail		
TITLE :	Pipe Penetration with Shrink Sleeve		
NUMBER :	SNCRC-D4b	SCALE :	1:3
DRAWN BY :	NKT	DATE :	20-July-2022
<p>EQUUS Waterproof Membrane Details are specially drawn for use by Local Authorities, Building Contractors, Equus Applicators, Architects and design professionals. All details are drawn to assist in the development of project specific details. Details may be modified where necessary to accommodate job specific requirements but must be approved by Equus Industries Ltd. All components must be supplied by Equus Industries Ltd. Equus reserves the right to alter or upgrade details at any time without prior notice.</p>			

