

- ① Reinforced concrete slab
- ② EQUUS SOPREMA Peel & Stick primer
- ③ EQUUS SOPREMA Colphene 3000, Vapour barrier
- ④ EQUUS SOPREMA SOPRA-ISO Silver PIR thermal insulation (or equivalent)
- ⑤ EQUUS SOPREMA DeboTack 2.5 T/F C175 Aero, base sheet
(Partially bonded, self-adhesive)
- ⑥ EQUUS SOPREMA DuO HT 4 WGG/F C180 Firecare Landscape, cap sheet
(Fully bonded, torch-on)
- ⑦ EQUUS SOPREMA cap sheet as separate piece over timber upstand
- ⑧ Plywood Plinth

- ⑨ Square fantech cowls
- ⑩ EQUUS SOPREMA Alsan Mastic 2200 bitumen sealant
- ⑪ Geo-textile separation layer
- ⑫ Round pebble stones
- ⑬ Metal grating, Gravel guard
- ⑭ EQUUS SOPREMA Sopradrain 10G or Danodren H15,
drainage and protection layer
- ⑮ Green roof substrate and vegetation

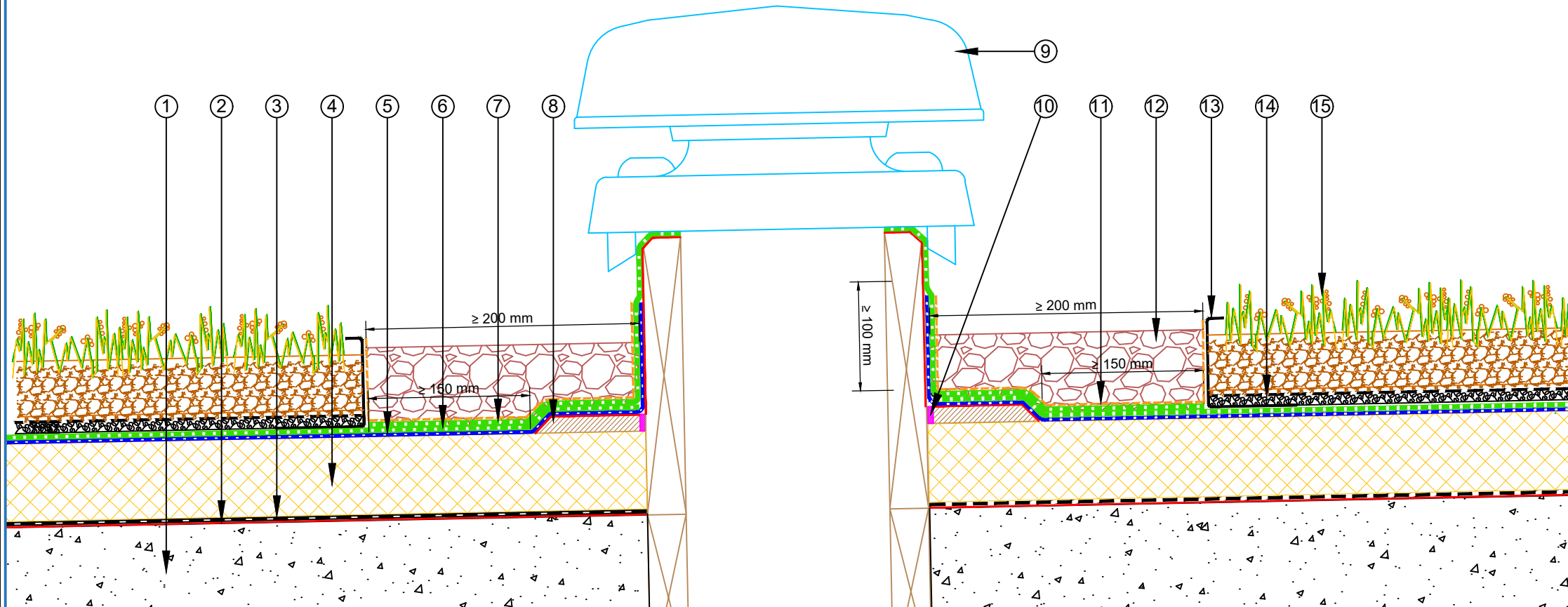

PROJECT :	EQUUS SOPREMA Warm Green Roof Standard on Concrete		
TITLE :	Square fantech cowls Detail		
NUMBER :	SDGWC-D6a	SCALE :	NTS
DRAWN BY :	NKT	DATE :	27-Apr-2023
		REVISED :	

Equus Waterproof Membrane Details are specially drawn for use by Local Authorities, Building Contractors, Equus Applicators, Architects and design professionals. All details are drawn to assist in the development of project specific details. Details may be modified where necessary to accommodate job specific requirements but must be approved by Equus Industries Ltd. All components must be supplied by Equus Industries Ltd. Equus reserves the right to alter or upgrade details at any time without prior notice.



E-mail : admin@equus.co.nz
Web : www.equus.co.nz

