

- ① Concrete Substrate
- ② EQUUS SOPREMA Peel & Stick primer
- ③ EQUUS SOPREMA Colphene 3000, Vapour barrier
- ④ EQUUS SOPREMA SOPRA-ISO Silver PIR thermal insulation (or equivalent)
- ⑤ Plywood Plinth
- ⑥ EQUUS SOPREMA DeboTack 2.5 T/F C175 Aero, base sheet (Partially bonded, self-adhesive)
- ⑦ Roof drain outlet flange
- ⑧ EQUUS SOPREMA DuO HT 4 WGG/F C180 Firecare Landscape, cap sheet (Fully bonded, torch-on)
- ⑨ Roof drain outlet
- ⑩ Adjustable Inspection Chamber
- ⑪ Geo-textile separation layer
- ⑫ Round pebble stones
- ⑬ Metal grating, Gravel guard
- ⑭ EQUUS SOPREMA Sopradrain 10G or Danodren H15, drainage and protection layer
- ⑮ Green roof substrate and vegetation

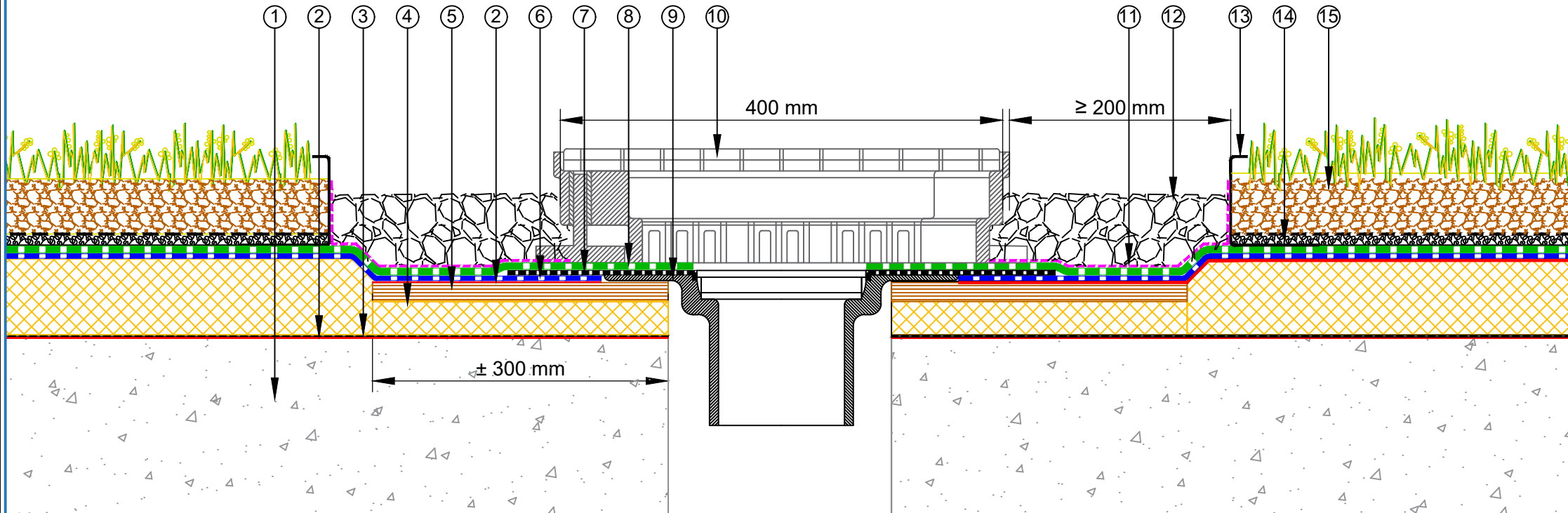

E-mail : admin@equus.co.nz
 Web : www.equus.co.nz

PROJECT :	EQUUS SOPREMA Warm Green Roof Standard on Concrete		
TITLE :	Rainwater Outlet		
NUMBER :	SDGWC-D4	SCALE :	1:5
DRAWN BY :	NKT	DATE :	03-Mar-2023
		REVISED :	

Equis Waterproof Membrane Details are specially drawn for use by Local Authorities, Building Contractors, Equis Applicators, Architects and design professionals. All details are drawn to assist in the development of project specific details. Details may be modified where necessary to accommodate job specific requirements but must be approved by Equis Industries Ltd. All components must be supplied by Equis Industries Ltd. Equis reserves the right to alter or upgrade details at any time without prior notice.

