

- ① Plywood Deck
- ② EQUUS SOPREMA Sopradere Quick primer
- ③ EQUUS SOPREMA DeboTack 2.5 T/F C175, base sheet
- ④ EQUUS SOPREMA DuO HT 4 WGG/F C180 Firecare Landscape, cap sheet
- ⑤ Metal grating, Gravel guard
- ⑥ EQUUS SOPREMA Sopradrain 10G or Danodren H15, drainage and protection layer
- ⑦ Green Roof substrate and vegetation
- ⑧ Geo-textile separation layer
- ⑨ Round pebble stones
- ⑩ EQUUS SOPREMA cap sheet as separate piece
- ⑪ EQUUS bitumen fillet or approved alternative
- ⑫ EQUUS Matacyl C-profile
- ⑬ EQUUS Alsan Mastic 2200 bitumen sealant

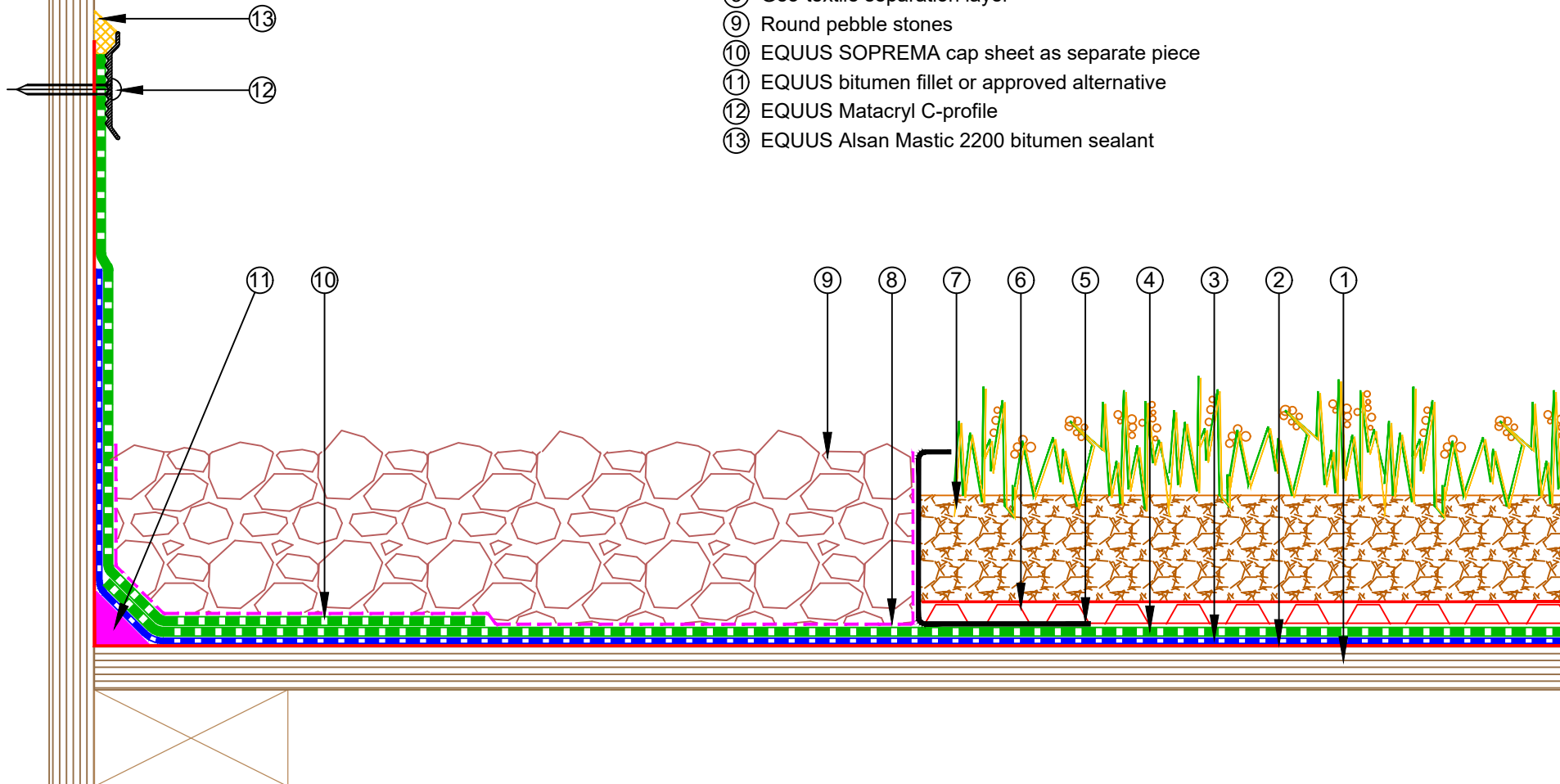

| | | | | | |
|------------|---|--------|-------------|-----------|--|
| PROJECT : | EQUUS SOPREMA Cold Extensive Green Roof Standard on Plywood | | | | |
| TITLE : | Parapet Detail | | | | |
| NUMBER : | SDCGP-D2a | | SCALE : | NTS | |
| DRAWN BY : | NKT | DATE : | 02-Mar-2024 | REVISED : | |

Equus Waterproof Membrane Details are specially drawn for use by Local Authorities, Building Contractors, Equus Applicators, Architects and design professionals. All details are drawn to assist in the development of project specific details. Details may be modified where necessary to accommodate job specific requirements but must be approved by Equus Industries Ltd. All components must be supplied by Equus Industries Ltd. Equus reserves the right to alter or upgrade details at any time without prior notice.

