

NOTE: Fastener spacing to follow De Boer project specific engineered fixing plan.

NOTE: Contact Equus for a project specific detail if differential movement between roof deck and wall is to be expected.

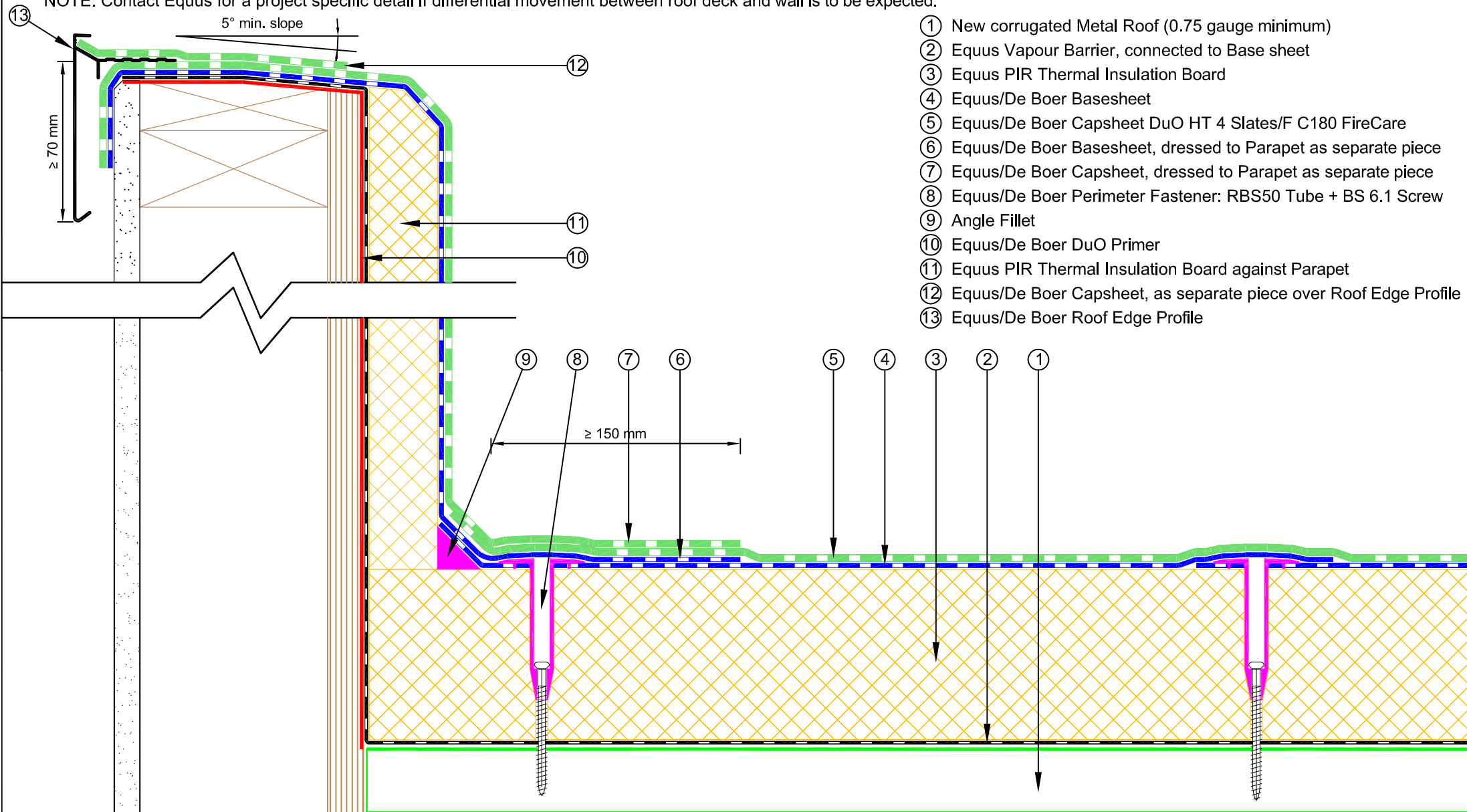

- ① New corrugated Metal Roof (0.75 gauge minimum)
- ② Equus Vapour Barrier, connected to Base sheet
- ③ Equus PIR Thermal Insulation Board
- ④ Equus/De Boer Basesheet
- ⑤ Equus/De Boer Capsheet DuO HT 4 Slates/F C180 FireCare
- ⑥ Equus/De Boer Basesheet, dressed to Parapet as separate piece
- ⑦ Equus/De Boer Capsheet, dressed to Parapet as separate piece
- ⑧ Equus/De Boer Perimeter Fastener: RBS50 Tube + BS 6.1 Screw
- ⑨ Angle Fillet
- ⑩ Equus/De Boer DuO Primer
- ⑪ Equus PIR Thermal Insulation Board against Parapet
- ⑫ Equus/De Boer Capsheet, as separate piece over Roof Edge Profile
- ⑬ Equus/De Boer Roof Edge Profile