

NOTE: Fastener spacing to follow de Boer project specific engineered fixing plan.

Shrink Sleeve	
Internal diameter Body	Sleeve shrinkable to
18 mm	8 mm
22 mm	12 mm
42 mm	22 mm
55 mm	42 mm
66 mm	55 mm
88 mm	66 mm
110 mm	88 mm

- ① Plywood Deck
- ② Equus Vapour Barrier
- ③ Equus/De Boer Basesheet
- ④ Equus/De Boer Fastener: RBS50 Tube + S/S Screw
- ⑤ Equus PIR Thermal Insulation Board
- ⑥ Equus/De Boer Basesheet, over Plywood Plinth
- ⑦ Equus/De Boer Capsheet DuO HT 4 Slates/F C180 FireCare
- ⑧ Equus/De Boer Capsheet, as separate piece over Shrink Sleeve
- ⑨ Plywood Plinth
- ⑩ De Boer bitumen Flange attached to Shrink Sleeve Body
- ⑪ Equus/De Boer DuO Kit Sealant
- ⑫ Shrink Sleeve Body internal diameter 55 mm
- ⑬ Shrink Sleeve

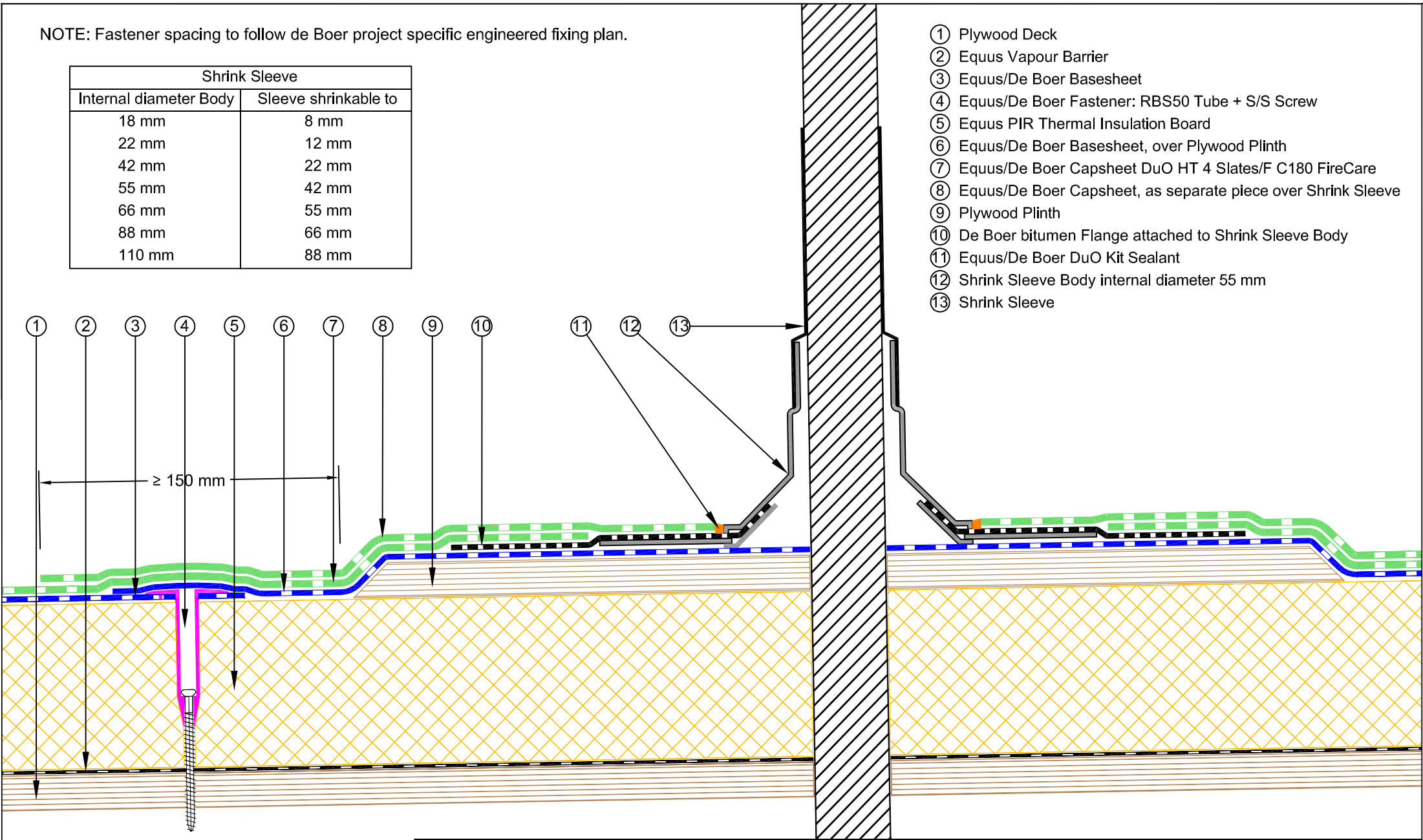



E-mail : admin@equus.co.nz
Web : www.equus.co.nz

DuOtherm Warm Roof on Plywood Standard Pipe Penetration with De Boer Shrink Sleeve

Equus/De Boer Waterproof Membrane Details are specially drawn for use by Local Authorities, Building Contractors, Equus Applicators, Architects and design professionals. All details are drawn to assist in the development of project specific details. Details may be modified where necessary to accommodate job specific requirements but must be approved by Equus Industries Ltd. All components must be supplied by Equus Industries Ltd. Equus Industries Ltd. reserves the right to alter or upgrade details at any time without prior notice.

Drawing No: **DBDTP-D5**

Scale: **1:3 @ A4**

Drawn by: **JPR**

Date: **04/10/2016**



de boer
waterproofing solutions
E-mail : info@deboer.be
Web : www.deboer.be