

- ① Plywood Deck
- ② EQUUS Sopradere Quick or Aquadere bitumen primer
- ③ EQUUS DeboPlast, DeboFlex or Debotack 2.5 T/F C175 base sheet
- ④ EQUUS DuO High Tech 4 Slates/F C180 Firecare cap sheet
- ⑤ EQUUS Capsheet as separate piece over Roof edge profile
- ⑥ S/S Clamp Ring
- ⑦ Metal Pipe Penetration with gooseneck and installation Flange

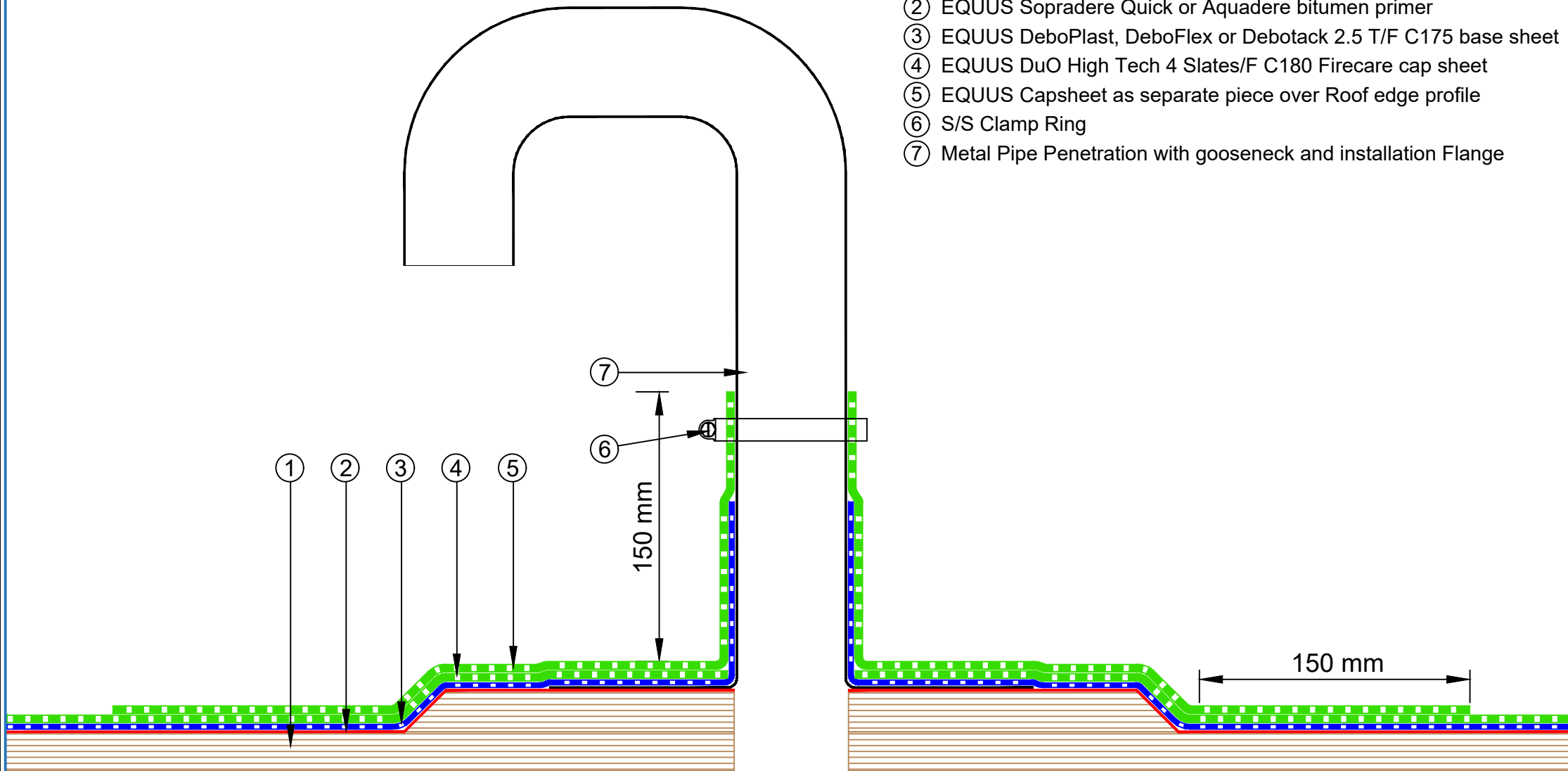

E-mail : admin@equus.co.nz
 Web : www.equus.co.nz

| | | | | | |
|------------|---|--------|-------------|-----------|-----|
| PROJECT : | Cold Roof on Plywood Standard Detail | | | | |
| TITLE : | Pipe Penetration Solar PV Power Conduit | | | | |
| NUMBER : | SDCRP-D18a | | | SCALE : | NTS |
| DRAWN BY : | NKT | DATE : | 04-Dec-2021 | REVISED : | |

Equus Waterproof Membrane Details are specially drawn for use by Local Authorities, Building Contractors, Equus Applicators, Architects and design professionals. All details are drawn to assist in the development of project specific details. Details may be modified where necessary to accommodate job specific requirements but must be approved by Equus Industries Ltd. All components must be supplied by Equus Industries Ltd. Equus reserves the right to alter or upgrade details at any time without prior notice.

