

- ① Site concrete
- ② EQUUS SOPREMA DeboFlex 2.5 T/F C175, 1st layer (heat-welded)
- ③ EQUUS SOPREMA SOPRAJOINT (laps heat-welded)
- ④ EQUUS SOPREMA DeboFlex 2.5 T/F C175, (reinforcement,heat-welded)
Minimum 150 mm reinforcement strip centered on the edge of the flange
- ⑤ EQUUS SOPREMA DeboFlex 2.5 T/F C175, 2nd layer (heat-welded)
- ⑥ Rigid support, 300 mm cover board
- ⑦ EQUUS SOPREMA Colphene 3000, 500 mm
- ⑧ EQUUS SOPREMA DeboTack 2.5 T/F C175

- ⑨ EQUUS SOPREMA DeboFlex 3.5 CS/F K180 Special
- ⑩ Waterstop
- ⑪ Rod foam
- ⑫ Sealant

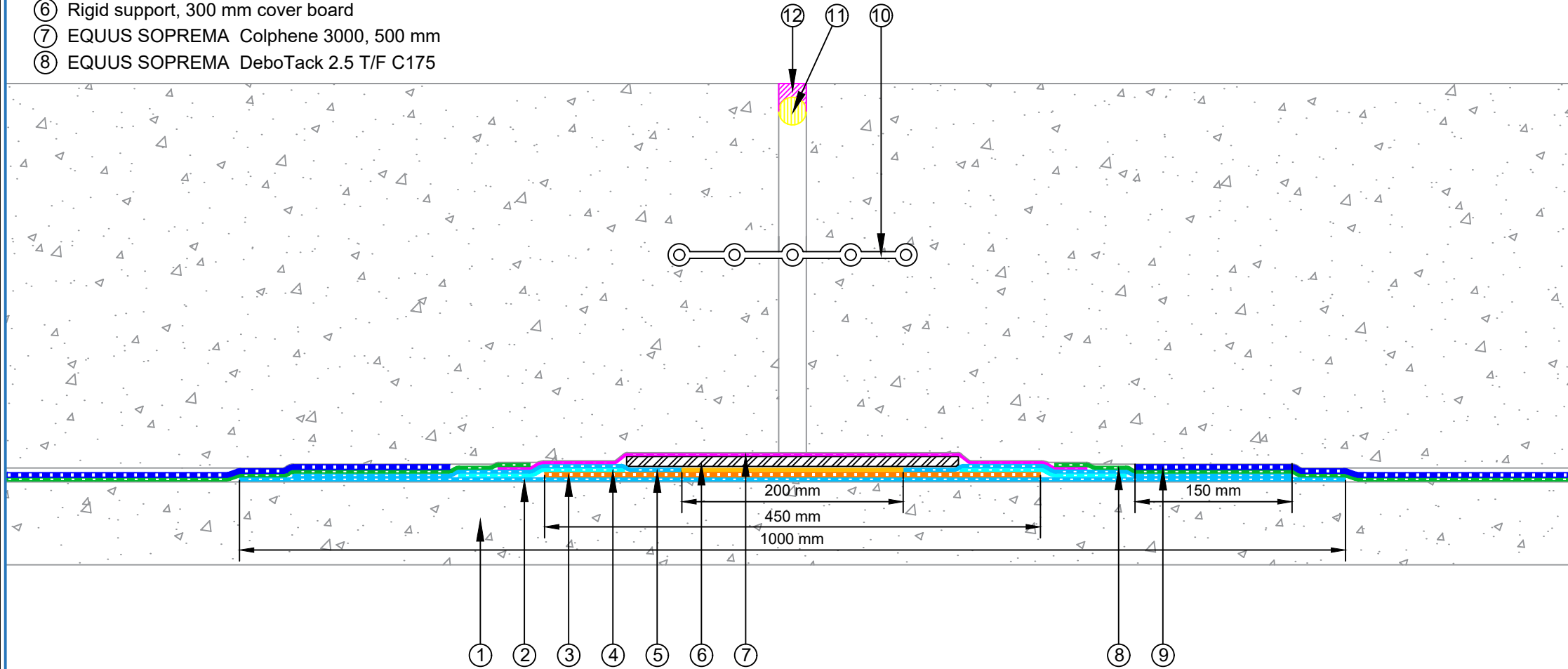

PROJECT :	Belowgrade Waterproofing Detail - Deboflex		
TITLE :	Seismic joint detail		
NUMBER :	SDBWS-D9a	SCALE :	1:5
DRAWN BY :	NKT	DATE :	06-Aug-2022
		REVISED :	

Equus Waterproof Membrane Details are specially drawn for use by Local Authorities, Building Contractors, Equus Applicators, Architects and design professionals. All details are drawn to assist in the development of project specific details. Details may be modified where necessary to accommodate job specific requirements but must be approved by Equus Industries Ltd. All components must be supplied by Equus Industries Ltd. Equus reserves the right to alter or upgrade details at any time without prior notice.

