

- ① Concrete Deck
- ② EQUUS SOPREMA ANTIROCK primer
- ③ EQUUS SOPREMA ANTIROCK
- ④ EQUUS SOPREMA Duo HT 4 AGR/F C180 Firecare
- ⑤ EQUUS SOPREMA DeboFlex 2.5 T/F C175, reinforcement strip
- ⑥ C-Profile termination bar with Alsan Mastic 2200 bitumen sealant
- ⑦ Overflashing termination bar
- ⑧ EQUUS SOPREMA Alsan Mastic 2200 bitumen sealant
- ⑨ Asphalt

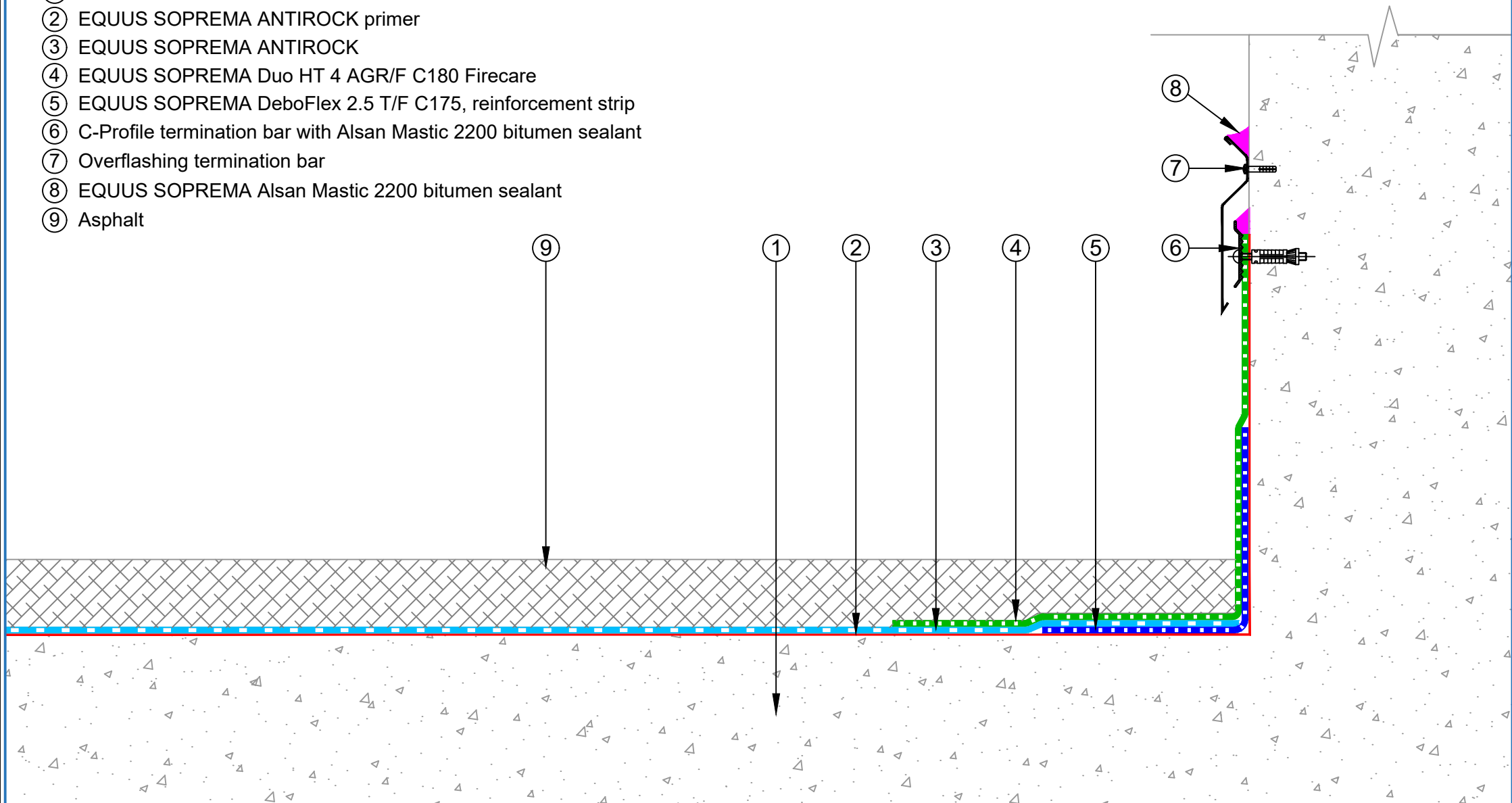

PROJECT :	ANTIROCK Standard Detail				
TITLE :	Parapet Detail				
NUMBER :	SACCC-D2a			SCALE :	NTS
DRAWN BY :	NKT	DATE :	10-May-2023	REVISED :	

Equus Waterproof Membrane Details are specially drawn for use by Local Authorities, Building Contractors, Equus Applicators, Architects and design professionals. All details are drawn to assist in the development of project specific details. Details may be modified where necessary to accommodate job specific requirements but must be approved by Equus Industries Ltd. All components must be supplied by Equus Industries Ltd. Equus reserves the right to alter or upgrade details at any time without prior notice.

